

OWNER'S MANUAL

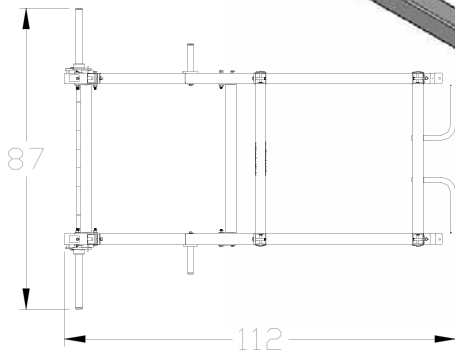

XXL-2960
L 112" W 86" H 100"

XXL-2960 **SUPER RACK/SMITH MACHINE**

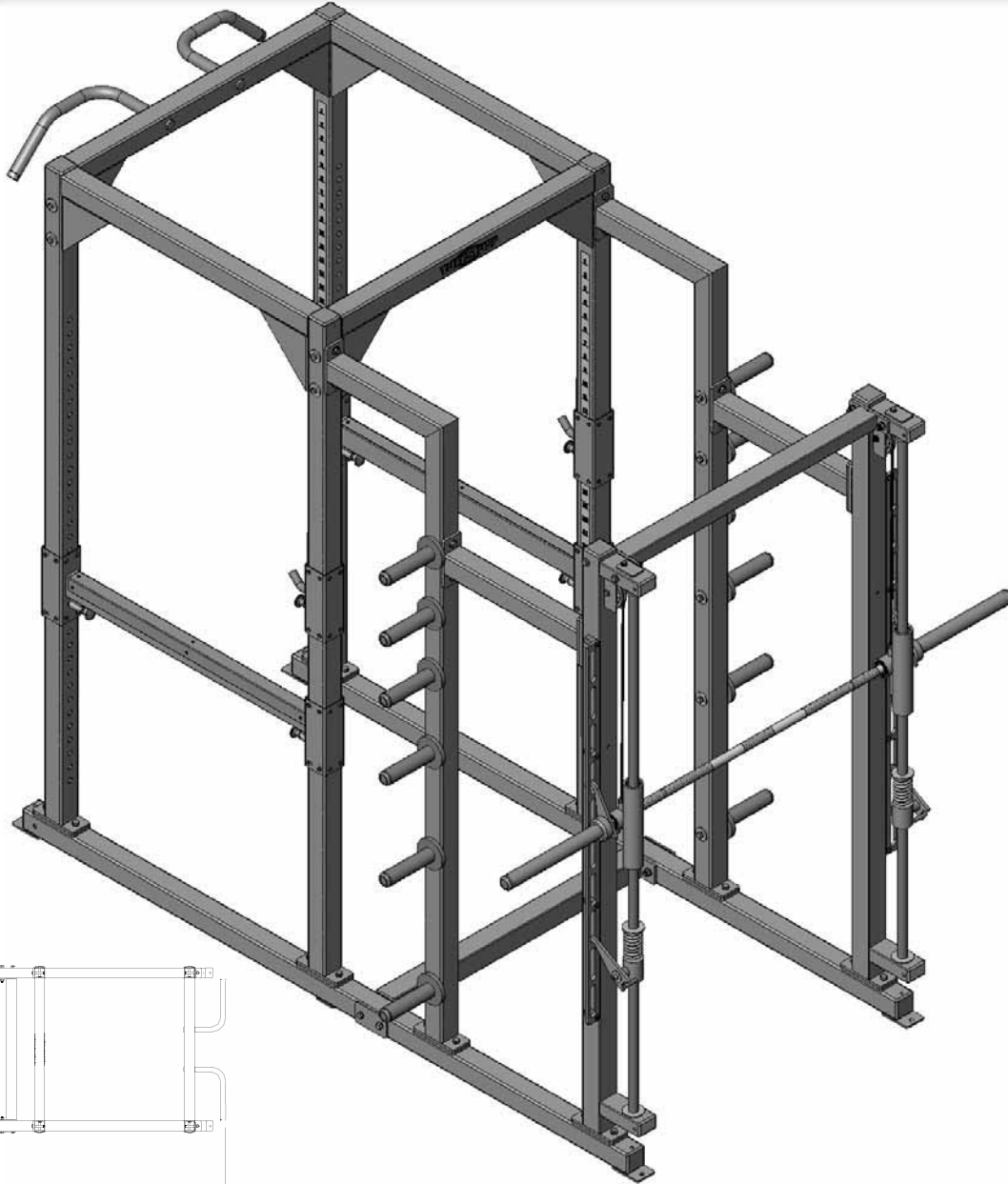
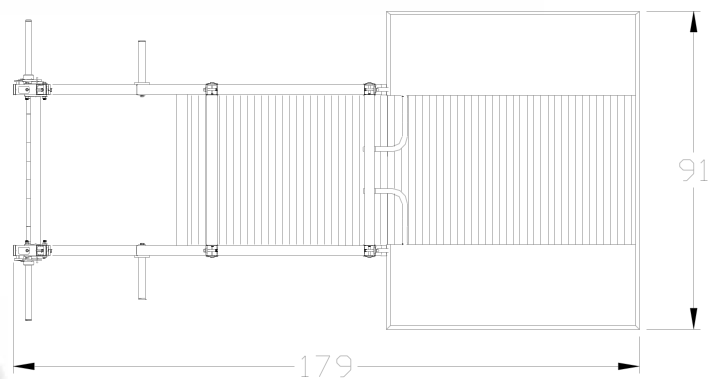

XXL-2960 / XXL-912
L 179" W 91" H 100"

AMERICA'S PREMIER XXL SUPER RACKS

COLOR CHART
 GRAY= SUB-ASSEMBLY PARTS
 BLACK= HARDWARE

XXL-2960 Parts List

XXL-2960 Rev0

Item No.	DESCRIPTION	Rev.	Part No.	Qty.	Item No.	DESCRIPTION	Part No.	Qty.
1	BEARING HOUSING LEFT	0	UP2864	1	44	DECAL-DANGER TIGHTEN THIS RET..., 3/4 X 1-1/2	BNH0142	6
2	BEARING HOUSING RIGHT	0	UP2863	1	45	DECAL-FOR BEST PERFORMANCE 1-1/4 X 1-1/2	BNH0143	4
3	BOTTOM CONNECTOR	1	UP3084	1	46	DECAL-NUMBERS 1-35 (TEFLON)	BNH1349	4
4	BOTTOM SIDE FRAME LEFT	1	UP3399	1	47	DECAL-WARNING KEEP HANDS AND FINGERS...	BNH0620	2
5	BOTTOM SIDE FRAME RIGHT	1	UP3398	1	48	FLAT HEAD SOCKET CAP SCREW B/O 3/8-16 X 1	BNH0222	8
6	BRONZE SPACER 0.64 ID X 1.53 OD X 0.44 THK	0	UP2913	2	49	FLAT PHILLIPS SCREW ZINC # 5 X 1/2	BNH1481	4
7	BRONZE SPACER 1.03 ID X 1.93 OD X 0.56 THK	0	UP2912	2	50	FLAT WASHER 1/2 ID X 1 3/4 OD X 3/16 THICK	BNH0241	28
8	CARRIAGE	2	UP2696	2	51	FLAT WASHER SAE B/O 1/2"	BNH0238	36
9	CHROME OLYMPIC ADAPTER	0	UP2914	2	52	FLAT WASHER SAE B/O 3/8"	BNH0239	6
10	CHROME OLYMPIC BAR	0	UP2915	1	53	FLAT WASHER USS B/O 1 1/8"	BNH0659	4
11	COUNTER BALANCE 2 1/2 SQ X 17 1/4	2	UP2854	2	54	HEX HEAD CAP SCREW GR-5 B/O 1/2 13 X 1 1/2	BNH0727	28
12	COUNTER BALANCE CABLE	0	UP2862	2	55	HEX HEAD CAP SCREW GR-5 B/O 1/2-13 X 1	BNH0259	4
13	CROSS BRACE	0	UP3841	2	56	HEX HEAD CAP SCREW GR-5 B/O 1/2-13 X 4 1/2	BNH0265	16
14	LAT TOP CROSS BRACE	0	UP3689	1	57	HEX HEAD CAP SCREW GR-5 B/O 1/2-13 X 4 1/4	BNH0291	12
15	LINEAR SHAFT 1 1/4 X 79 7/16	0	UP2320	2	58	SPRING 1 3/8" ID X 2" OD X 4" LONG	BNH0681	2
16	OLYMPIC ADAPTER	0	UP2596	12	59	HEX HEAD CAP SCREW GR-5 B/O 3/8-16 X 1	BNH0275	2
17	REAR TOP CROSS BRACE	1	UP2700	1	60	HEX HEAD CAP SCREW GR-5 B/O 3/8-16 X 2	BNH0279	2
18	REAR WEIGHT HOLDER LEFT	1	UP3382	1	61	HEX KEY ALLOY 3/32"	BNH0372	1
19	REAR WEIGHT HOLDER RIGHT	1	UP3381	1	62	HEX KEY ALLOY 5/32"	BNH0373	1
20	SAFETY HOOK	0	UP2859	2	63	HEX TAP BOLT GR-5 W/HOLE Z/P 1/2-13 X 1	BNH1049	4
21	SAFETY HOOK LEFT	0	UP2861	1	64	LARGE TUFFSTUFF LOGO DIAMOND SHAPE	BNH1324	2
22	SAFETY HOOK RIGHT	0	UP2860	1	65	LINEAR BEARING SUPER SMART SSU-20	BNH0629	4
23	SAFETY SPOTTER LEFT	0	UP2857	1	66	NYLON INSERT JAM LOCK NUT B/O 3/8-16	BNH0365	2
24	SAFETY SPOTTER RIGHT	0	UP2856	1	67	NYLON INSERT LOCK NUT B/O 1/2-13	BNH0212	26
25	SCRATCH PROTECTOR 1 X 1 7/8 X 40 3/4	0	UP3691	2	68	NYLON INSERT LOCK NUT B/O 5/8-1.5 mm	BNH1421	2
26	SELECTORIZED UPRIGHT	1	UP2881	4	69	NYLON STEM BUTTON .720" X .187"	BNH0533	32
27	SHAFT RETAINER	0	UP2858	2	70	NYLON STEM BUTTON 12.5 mm X 26 mm X 9.5 mm	BNH0547	96
28	SIDE TOP CROSS BRACE	0	UP2701	2	71	PUSH PULL PIN 5/8 X 2 21/32 ASSY STIFF SPRING	BNH1858	2
29	SINGLE BAR-CATCH	1	UP2703	2	72	PUSH PULL PIN 5/8 X 3 1/2 ASSY STIFF SPRING	BNH1855	4
30	SLOTTED PLATE 3/8 X 2 X 56	0	UP2855	2	73	R18-ZZ ROLLER BEARING	BNH0638	4
31	SMITH LINEAR PRESS SYSTEM LEFT UPRIGHT	0	UP3396	1	74	RETAINING RINGS SUPER 20	BNH0420	4
32	SMITH LINEAR PRESS SYSTEM RIGHT UPRIGHT	0	UP3397	1	75	ROLL PIN Z/P B/O 1/4 X 1 1/2	BNH0894	2
33	TOP CROSS BRACE	0	UP2853	1	76	RUBBER GRIP 1.1875 ID X .125 X 25	BNH0955	2
34	ALUMINUM BLIND RIVET 3/16" #AB66A		BNH0881	12	77	RUBBER INSERT CAP W/GROOVE 1.95 RD X 1	BNH1420	2
35	ALUMINUM CAP 1.270" RD. (CAP -125)		BNH0538	2	78	RUBBER WASHER 1 7/8 ID X 4 1/4 OD X 9/16 TK	BNH0933	12
36	ALUMINUM INSERT CAP 2 X 3		BNH1504	4	79	SOCKET SET SCREW ALLOY 10-32 X 1/8	BNH0473	4
37	ALUMINUM INSERT CAP 3 SQ X .120		BNH1505	6	80	DECAL-IMPORTANT FOR BEST PERFORMANCE...	BNH1894	4
38	ALUMINUM INSERT CAP 3 SQ X .188		BNH1506	4	81	SOCKET SET SCREW ALLOY 3/8-16 X 1/4	BNH0608	4
39	ALUMINUM PULLEY 3/8" X 4 1/2"		BNH0069	2	82	SPLIT LOCK WASHER B/O 1/2"	BNH0653	38
40	BUTTON HEAD SOCKET CAP SCREW B/O 1/4-20 X 3/8		BNH1346	18	83	SPLIT LOCK WASHER B/O 3/8"	BNH0658	4
41	BUTTON HEAD SOCKET CAP SCREW B/O 3/8-16 X 1		BNH0115	2	84	HEX KEY ALLOY 7/32"	BNH0575	1
42	CHROME WASHER 3/8 X 1 1/2		BNH1015	2	85	HEX KEY LONG ARM ALLOY 3/16"	BNH0371	1
43	DECAL-CAUTION 1 3/4 X 5 1/2		BNH0126	1	86	DECAL-DANGER ENGAGE SAFETY SPOTTER...	BNH1848	2

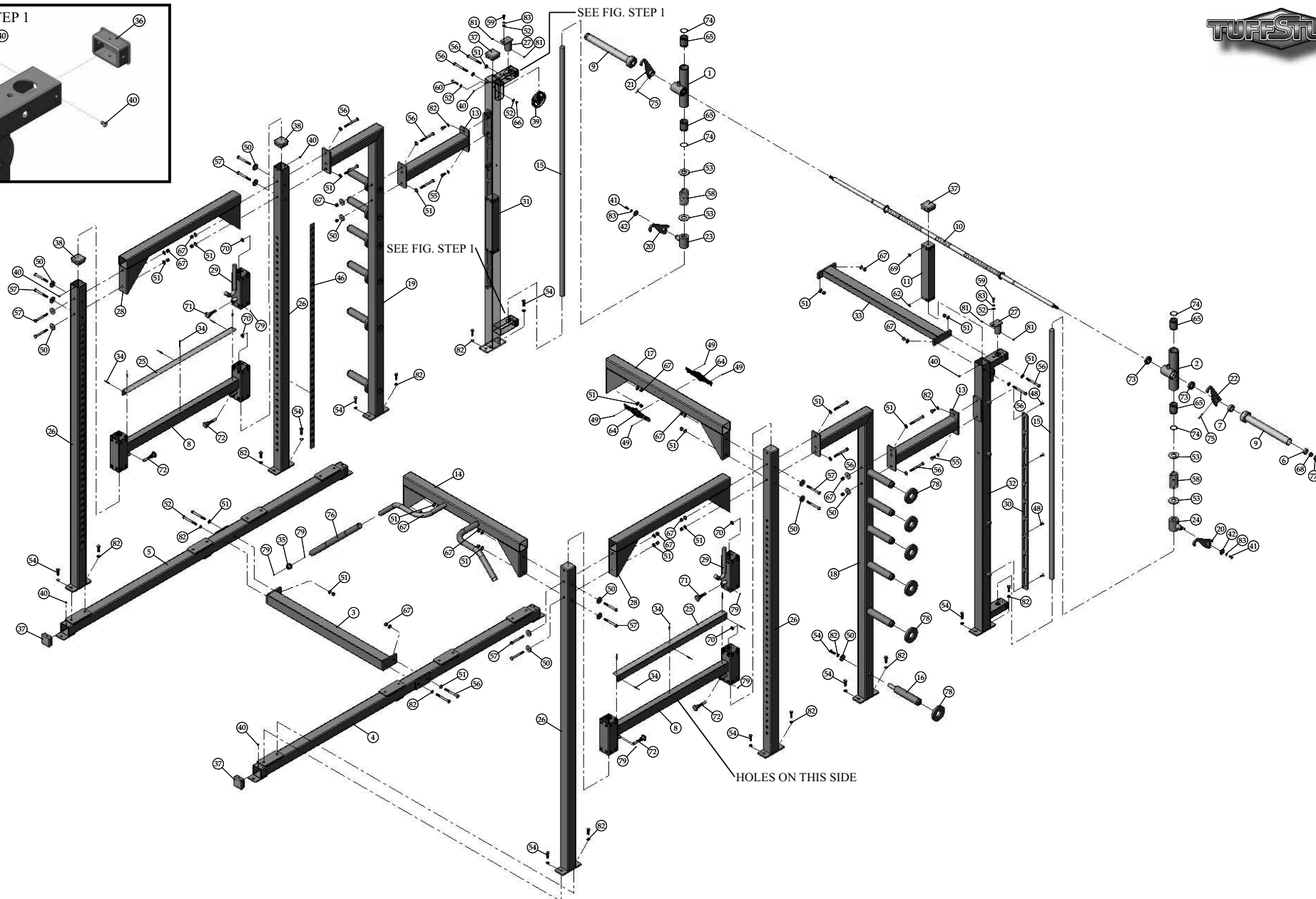
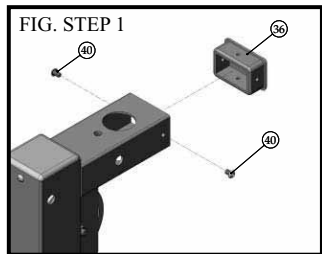

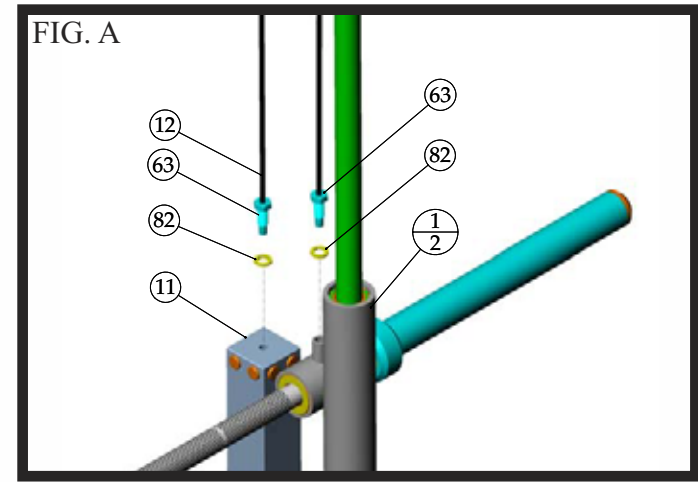
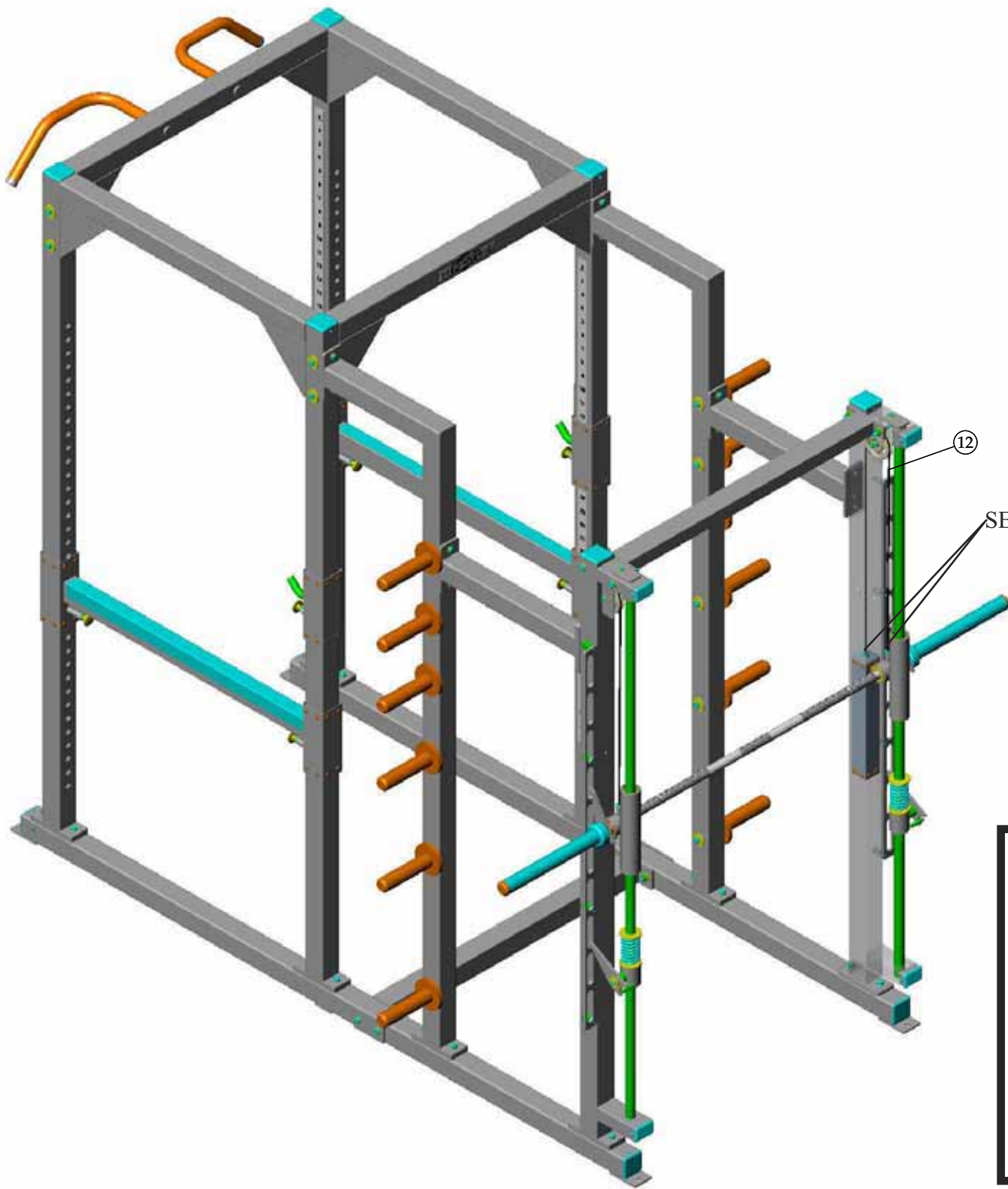

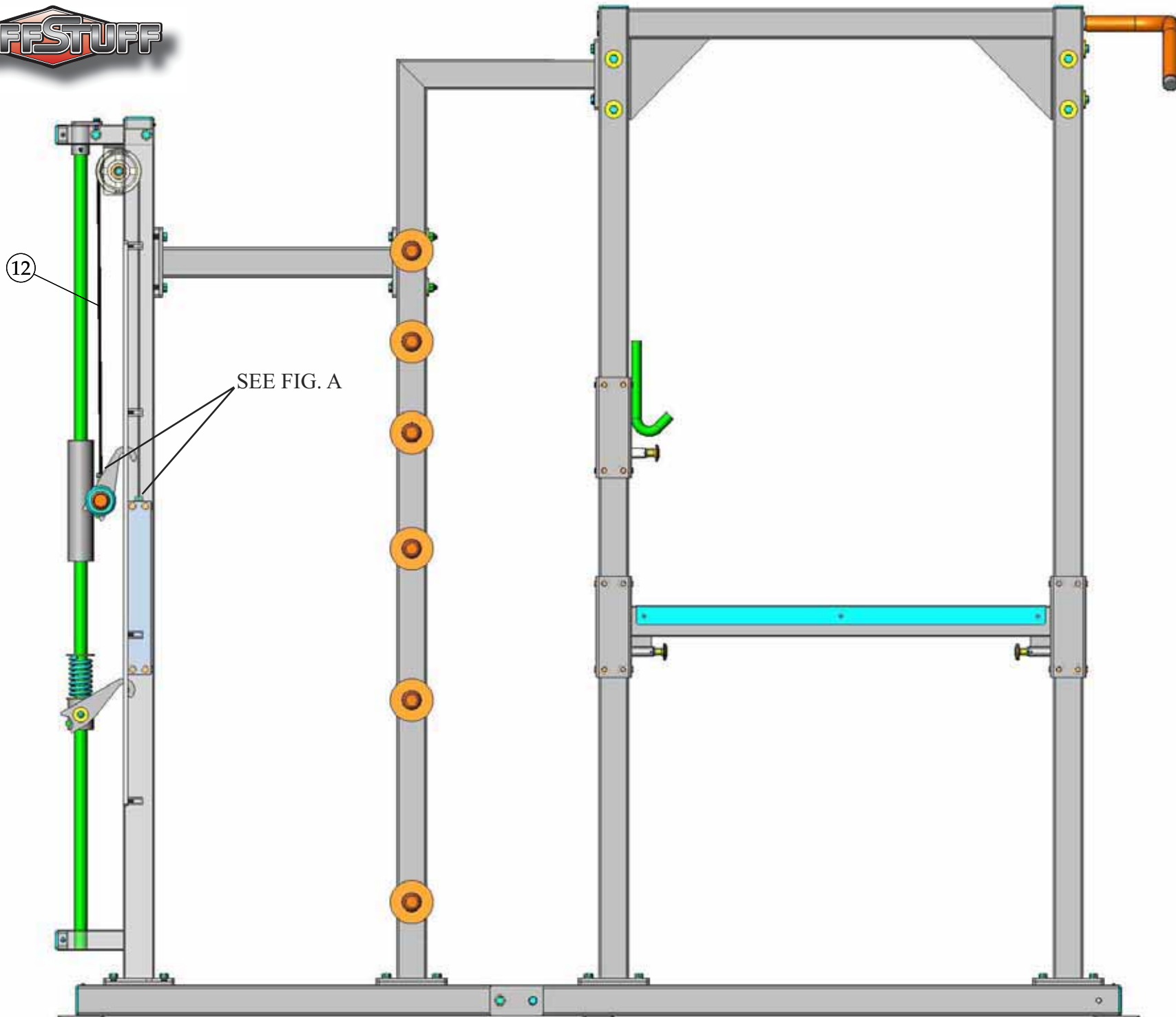

12

SEE FIG. A



TUFFSTUFF WARRANTY

TuffStuff warrants to the original purchaser that TuffStuff equipment will be free from defects in material and workmanship. All warranty periods begin to run from the date of delivery to the original purchaser. The warranty and remedies set forth herein are conditioned upon proper storage, installation, use and maintenance and conformance with any recommendations of TuffStuff. This warranty does not cover products not manufactured by TuffStuff or products which are altered without the express written consent of TuffStuff. This warranty as specified:

- 10-YEARS: structural frames and welds
- 1-YEAR: linear bearings, pull-pin components and moving parts
- 90-DAYS: finish & surface coatings, platforms, rubber grips, custom logos, rubber mats, hardware and items not specified

Warranties outside the U.S. may vary. Contact TuffStuff for details

The obligation of TuffStuff under this warranty is limited to repairing or replacing warranted defective parts, as TuffStuff may elect, at TuffStuff's facility in Pomona, California, without charge to purchaser for either parts or labor. Purchaser is responsible for installation of repaired or replaced parts, and all transportation and insurance costs on returned or replaced equipment to and from TuffStuff's facility in Pomona.

THE FOREGOING SHALL CONSTITUTE THE SOLE REMEDY OF THE PURCHASER AND THE SOLE LIABILITY OF TUFFSTUFF WITH REGARD TO WARRANTY. NO IMPLIED STATUTORY WARRANTY OR IMPLIED STATUTORY WARRANTY OF MERCHANTABILITY OR FITNESS FOR A PARTICULAR PURPOSE SHALL APPLY. IN NO EVENT, WHETHER AS A RESULT OF BREACH OF CONTRACT, WARRANTY, NEGLIGENCE OR OTHERWISE, SHALL TUFFSTUFF BE LIABLE FOR SPECIAL, INCIDENTAL OR CONSEQUENTIAL DAMAGES INCLUDING, BUT NOT LIMITED TO, LOSS OF PROFITS OR REVENUE, LOSS OF USE OF EQUIPMENT, COST OF CAPITAL, COST OF SUBSTITUTION EQUIPMENT, DOWNTIME COST, OR CLAIMS OF CUSTOMERS OR PURCHASER FROM SUCH DAMAGE.

This written warranty is the final, complete and exclusive agreement of the parties with respect to the quality or performance of the equipment and no action for breach of this written warranty or any implied warranty shall be commenced more than one (1) year after the accrual of the cause of action. No modification of this warranty or waiver of its terms shall be binding on either party unless approved in writing by an authorized representative of the party. Contact TuffStuff Fitness Equipment, Inc. at 1325 E. Franklin Avenue, Pomona, California 91766, before returning any defective equipment.

TuffStuff Fitness Equipment, Inc.

1325 E. Franklin Avenue

Pomona, CA 91766, USA

Ph: 909-629-1600 Fax: 909-629-4967

E-mail: service@tuffstuff.net www.tuffstufffitness.com