

VECTRA

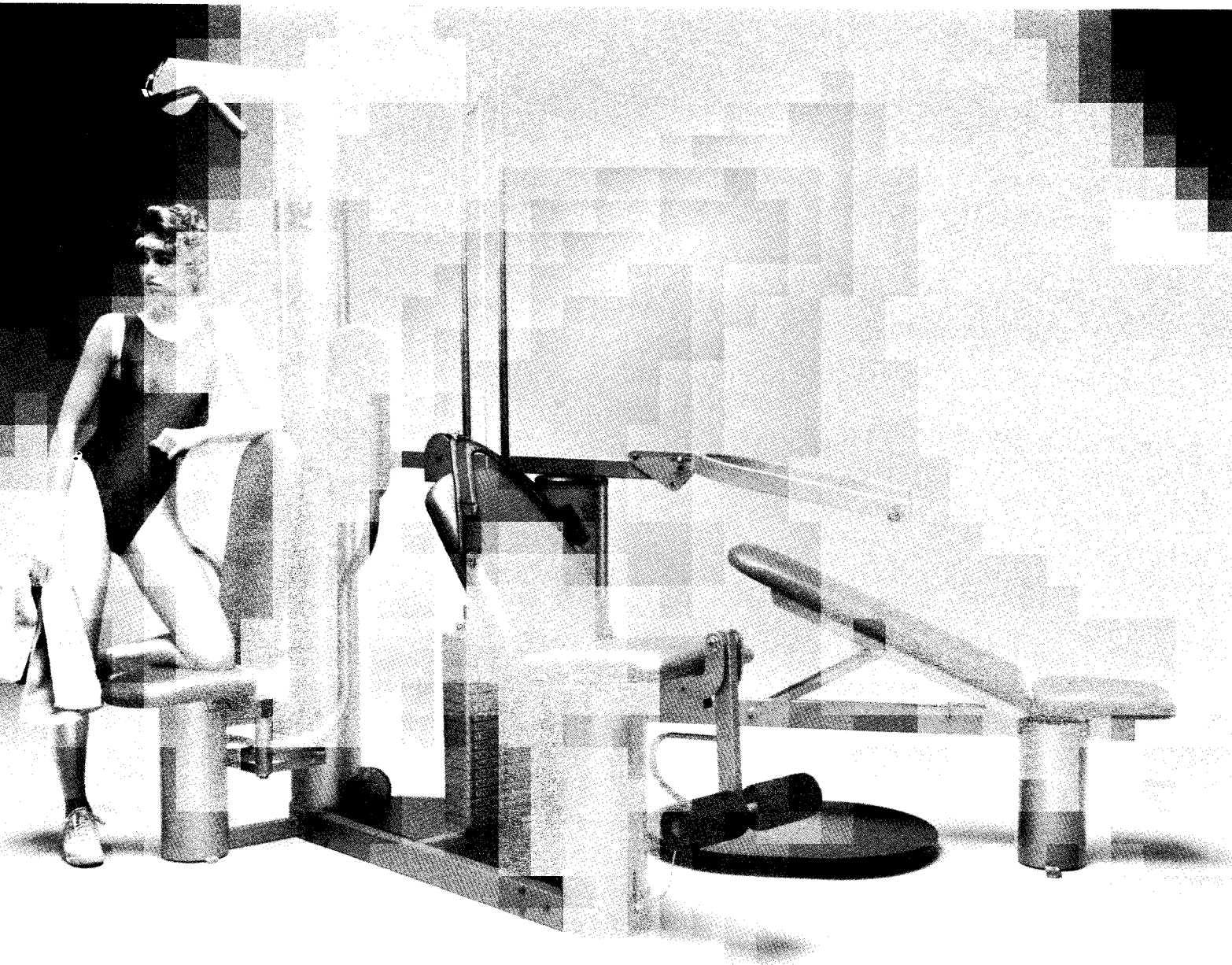

ON-LINE® 1500
OWNER'S MANUAL

Introduction

Your new Vectra On-Line® 1500 is designed and manufactured to provide you with many years of convenient and reliable service.

This owner's manual provides you with safety rules, assembly instructions, exercise program guidelines, and routine inspection and maintenance information to enable you to get the most from your gym. Please read through this manual carefully before you assemble and use your On-Line® 1500.

We at Vectra appreciate your selecting our On-Line® 1500 for your personal fitness program, and invite your questions and comments. We're sure that you'll be pleased with your new Vectra gym.

Safety Rules

WARNING

Serious injury can occur if struck by falling weights or moving parts. The risk that you assume by using this type of equipment can be reduced by obeying a few simple rules:

1. **IMPORTANT:** Cables are a wear item. It is your responsibility to prevent unexpected breakage. To do this, inspect every cable regularly. Pay particular attention to areas near the fittings at each end of each cable. Access panels are provided on columns for this purpose. Replace worn, frayed, or damaged cables immediately. Using or allowing a machine to be used with a suspect cable can result in serious injury.
2. Read and follow all instructions in your Owner's Manual and on your exercise chart. Additional copies are available from Vectra Fitness, Inc. or your dealer.
3. Consult your physician before beginning your exercise program.
4. Do not allow young children to use or play with this machine. Allow older children to use the machine only with adult supervision.
5. Keep head and limbs clear of weights and moving parts at all times.
6. Inspect the gym for loose or worn parts, damaged or frayed cables, broken weight plates, etc. Do not use or allow the machine to be used until any defective parts are repaired or replaced. Refer to the "Routine Inspection and Maintenance" section of this manual for specific inspection rules.
7. Insure that the weight selector pin is properly engaged in the selector shaft. Use only the factory supplied pin or a factory authorized replacement.
8. Insure that the locking mechanisms are properly engaged prior to lifting.
9. Obtain assistance to free jammed weight plates, pulleys, etc. Do not attempt to free jammed weight plates by yourself. Falling weight plates can cause serious injury.
10. Do not drop the weight plates. Lift only as much weight as you can control safely.

Tools Required: Wrenches: 7/16, 1/2, 9/16
 Hex Keys: 1/4, 5/16
 Philips Head #2 screwdriver
 Hammer

Assembly Instructions

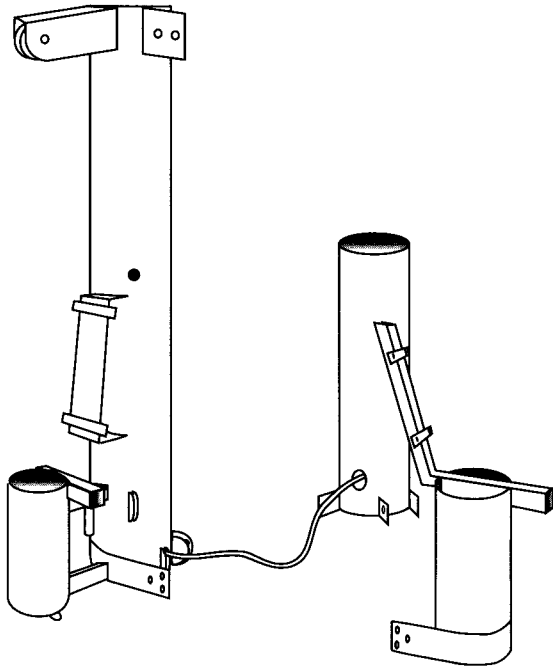

1. Select location for machine.

Set your machine up in a well lighted and well ventilated area where you will enjoy exercising. Use carpet remnants, etc. to protect floor if desired.

2. Unbox entire unit, **LEAVING ALL CABLE RETAINERS IN PLACE.**

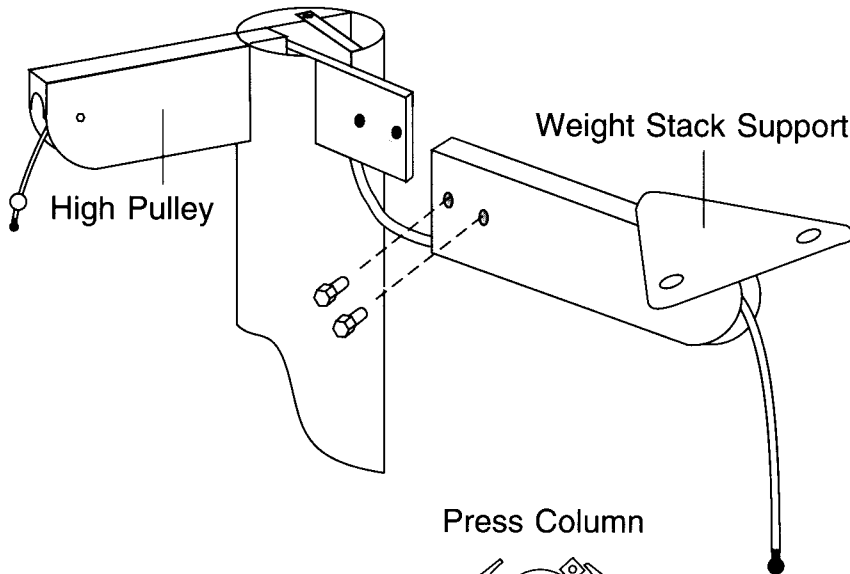

3. Attach weight stack support to main column.

Thread the cable over the pulley

(3/8-16x 1/2 hex screw, Qty: 2)

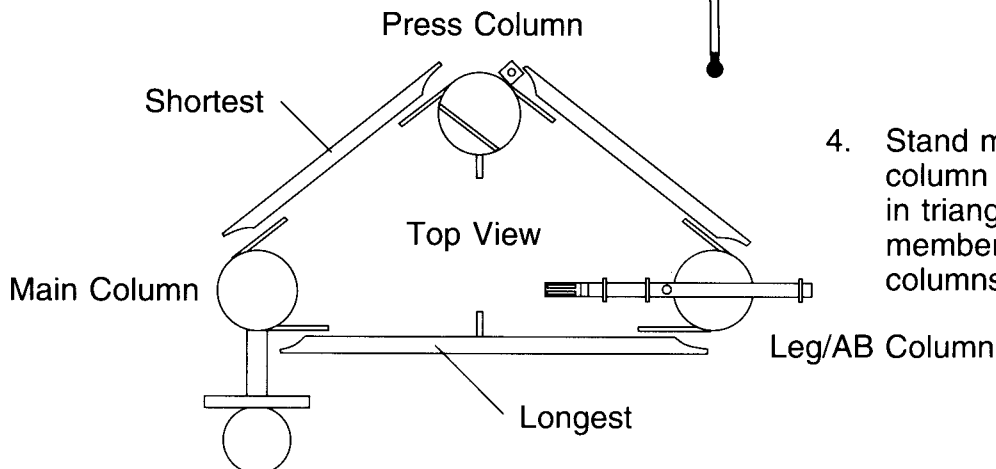

4. Stand main column, press column and leg/ab column up in triangle pattern. Lay frame members in place between columns as shown.

5. Attach the press station platform as the frame is bolted together.
(3/8-16 x 3/4 screws.)

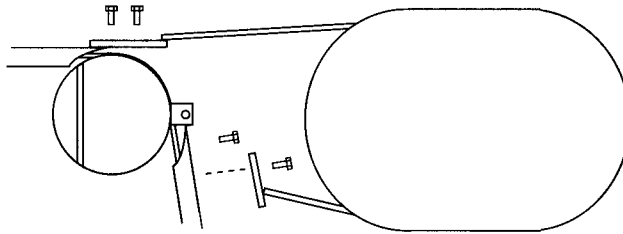

6. Install all frame screws loosely.
(3/8-16 x 3/4 screws.)

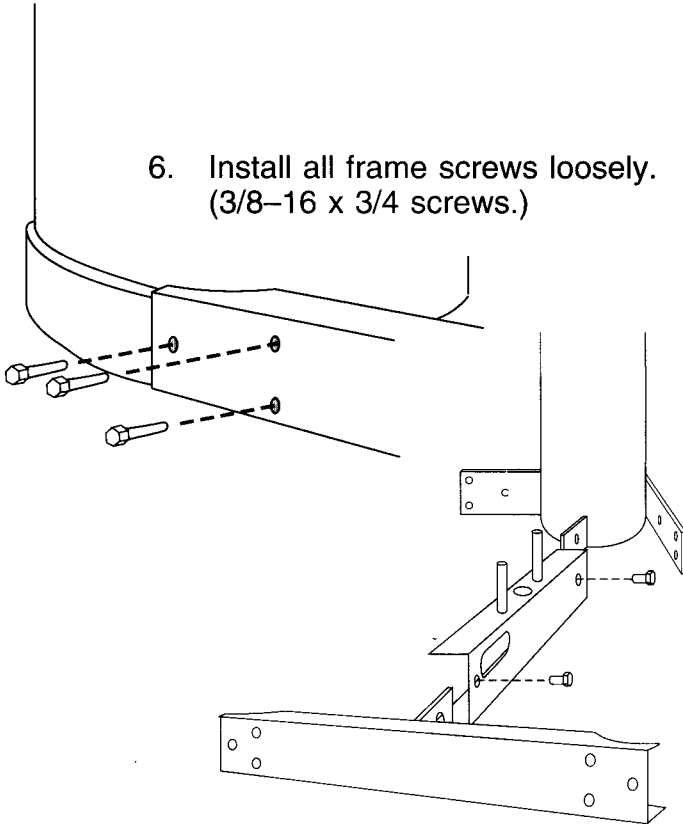

7. Install weight stack support stringer loosely.
(3/8-16 x 3/4 screws.)

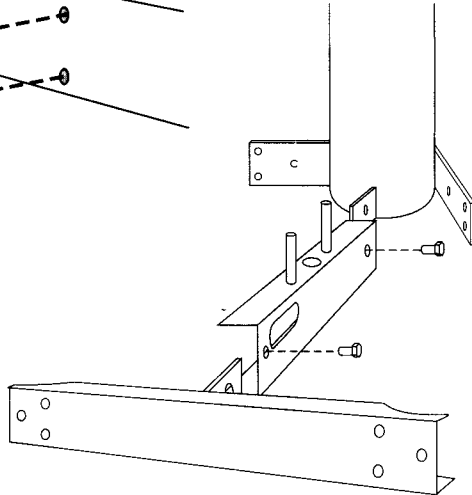

- 8a. Install press arm tightly.
(1/2-13 x 1 button-head screws.)
Use loctite per instructions provided with loctite.

- 8b. Place cap on press column.
Connect the hook at the top of the press column to the press arm.
Make sure cables are not twisted.

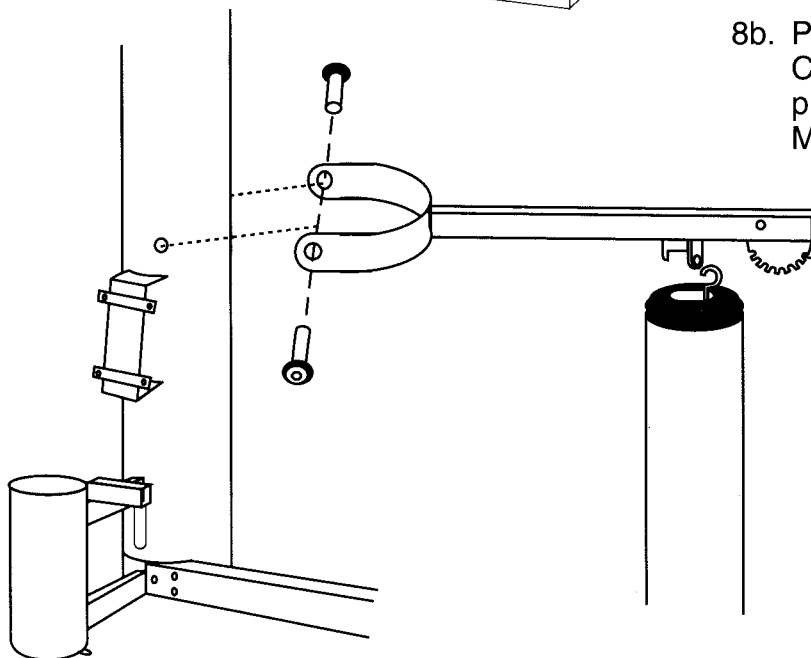

9. Align columns to vertical. Verify press arm aligns with top of press column.
TIGHTEN ALL FRAME MEMBER SCREWS.

10. Install press handlebar tightly. (1/2 X 1/2 shoulder bolts.)
Use loctite per instructions provided with loctite.

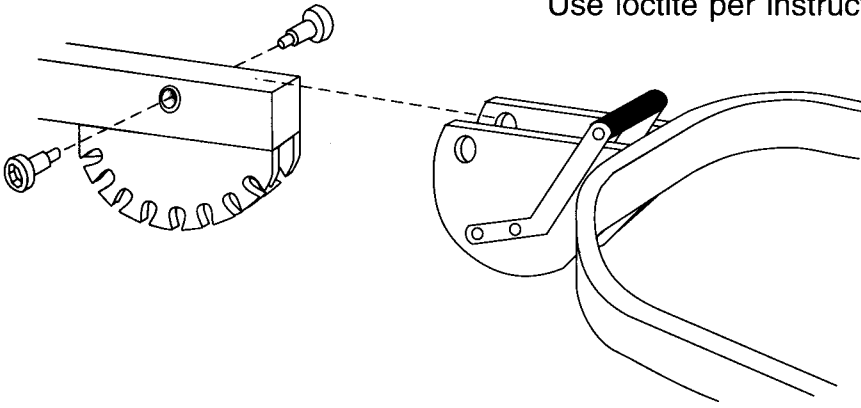

11. Install leg/ab seat bottom assembly on leg/ab station.
(1/4-20 x .50 philips screw.)

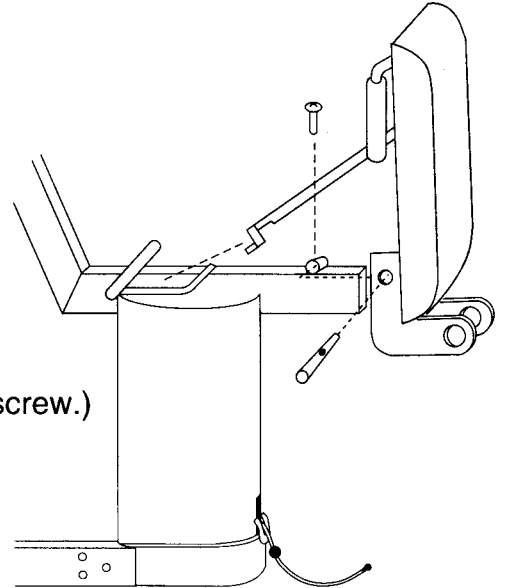

12. Install leg/ab back on leg/ab station.
Tighten mounting screws firmly.
(1/4-20 x 3/4 hex screws.)

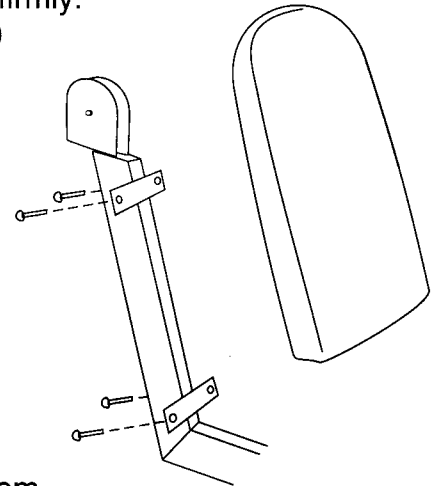
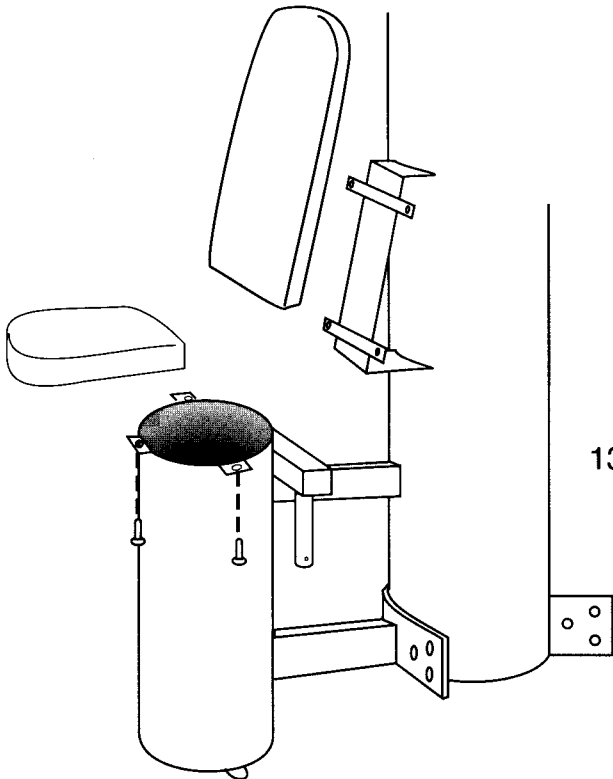

13. Install butterfly seat bottom and seat back. Tighten mounting screws firmly.
(1/4-20 x 3/4 hex screws.)

14 ,16.

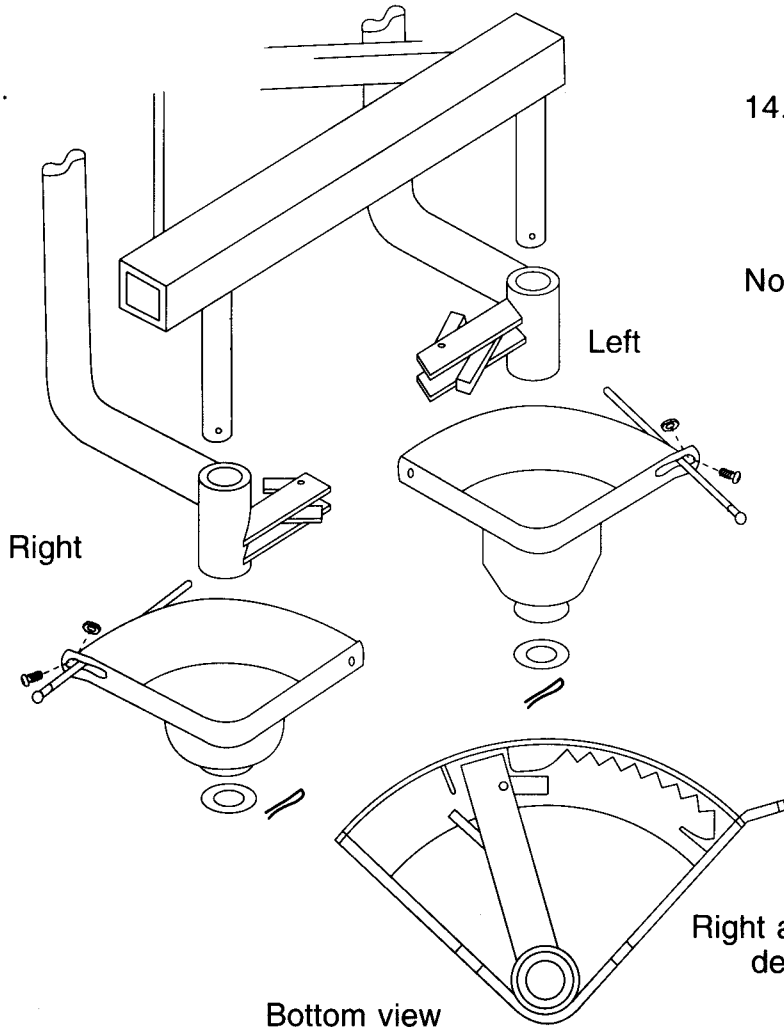

14. Install right butterfly arm on pivot bar. Tilt right cam to install. Install washer and then drive cotter pin in fully and bend end. Repeat for left side.
Note: Butterfly arms should now adjust pre stretch by click-ratcheting backwards to desired use or storage position. Pull butterfly arms around forward from rear-most storage position to re-set the ratchets.

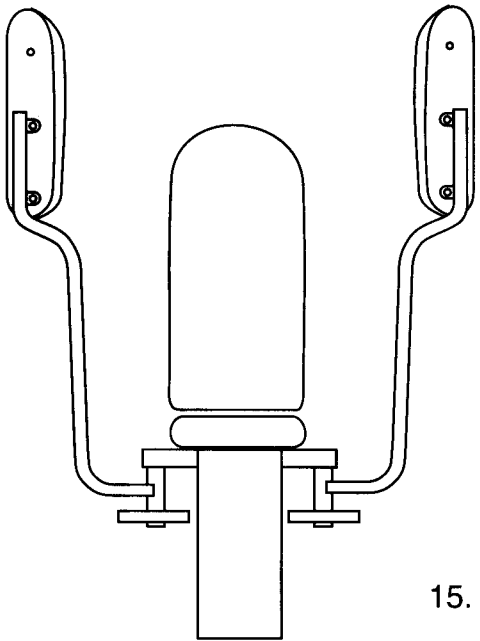

15.

15. Install butterfly arm pads.

16. Connect butterfly cables to butterfly cams. Tighten screw and nut.

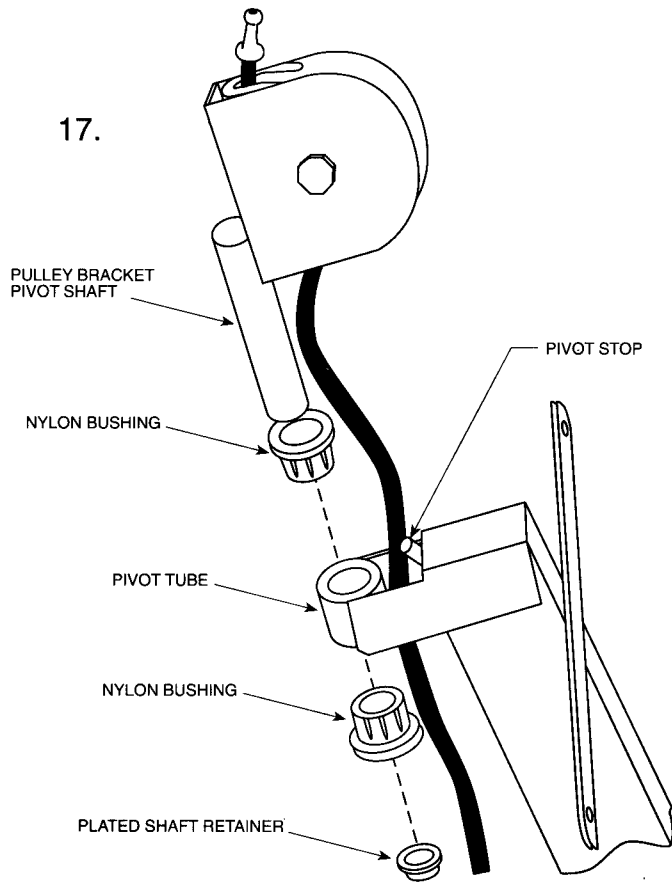

17. Push nylon bushings into pivot tube.
Insert pulley bracket pivot shaft through bushings.

Note: Make sure pulley bracket sides are on both sides of pivot stop. (Pulley bracket should be facing directly forward over cushions.)
Install plated shaft retainer with hammer. The pulley bracket should be able to pivot roughly 15 degrees to either side of straight ahead.

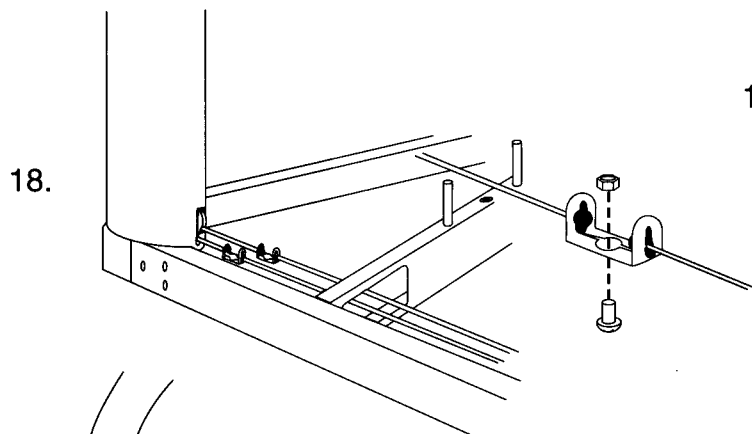

18. Being careful to not lose cable ends into columns, connect leg developer, and abdominal crunch cables to the cables at the base of the main column. Insure that the cables pass through the opening in the weight stack support stringer. Insure that the cables are not crossed.

PUT CABLE RETAINING SCREW THROUGH IN DIRECTION SHOWN.

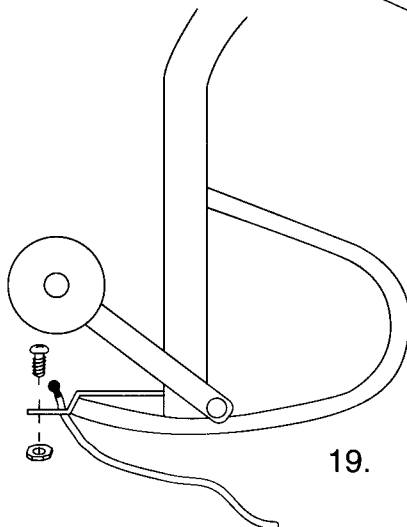

19. Connect leg developer to cable as shown.

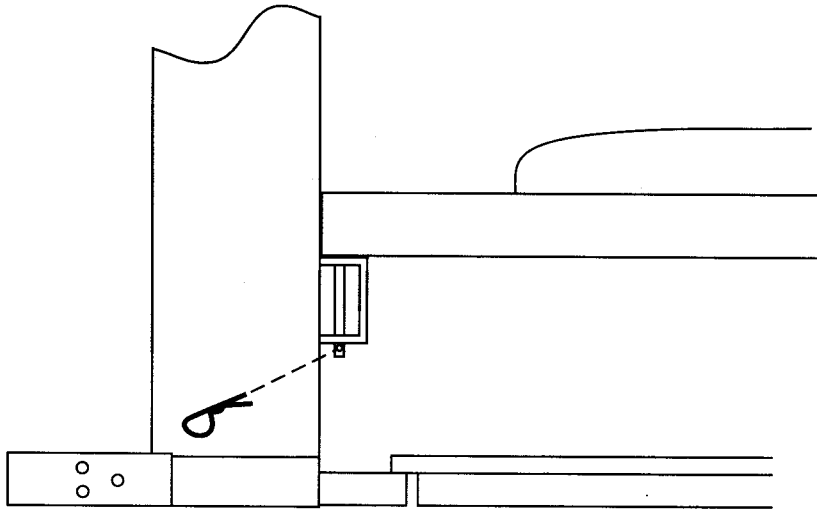

26. Attach incline bench bottom and seat back.
(1/4-20 x .75 hex screws.)
Attach the incline bench with the hairpin cotter.

27. Attach accessories to appropriate cables, i.e., lat bar to high pulley, abdominal strap to abdominal pulley, ankle strap to low pulley, etc.
28. Install triangular frame covers. Insert edge under weight stack, then drop in place.
29. Install weight stack number labels per instructions with labels.

**If you have any questions, PLEASE
contact the full-service dealer where
you purchased this machine.**

Exercise Program Guidelines

You already know that regular physical exercise is a key element in improving your general health and strength, raising your mental and physical energy levels, reducing your risk of cardiovascular disease, and enhancing your appearance. You'll be pleased by the way your Vectra gym will help you reach your personal fitness goals.

Weight resistance exercise with the On-Line® 1500 offers you many benefits.

- Weight settings are easily matched to your goals and fitness level.
- Progressive weight increases and regular exercise result in dramatic improvements in your fitness and appearance.
- Ergonomically correct stations enable you to concentrate on specific parts of your body.
- Vectra's patented On-Line® cable system lets you exercise efficiently. You can do a full body workout in just minutes, spending your fitness session exercising without fussing with your gym.
- Vectra's top quality design and construction will provide you with years of professional level exercise in your own home.

Your first step in getting the most from your On-Line® 1500 is to set up an exercise program tailored to your personal fitness objectives. The following sections will first provide you with general guidelines applicable to any program. Next, we will discuss a general purpose conditioning program and two supplementary specialized programs in more detail.

The following guidelines apply to any exercise program.

- First, be sure to consult your physician before beginning your exercise program. This is especially important if you are planning a rehabilitation program following a serious injury or illness.
- Use your exercise specialty dealer as a resource for information and advice. Your professional dealer can provide you with reference materials, help you contact sports clinics and personal trainers, and give you tips on staying motivated and following your program.
- Motivation is key to your success. Do anything you can to make your regular workouts pleasant and challenging, not just another dull chore. You might set a goal of bench pressing 20 more pounds in one month. Or try competing with a partner, or keeping a wall chart showing your progress.

By exercising regularly as described in the following sections, you will see a significant improvement in your performance in 4-8 weeks. And that's the best motivation of all!

- "No pain, no gain". Well, not exactly. You should always be aware of the difference between fatigue and pain. You can expect to feel tired after exercising, but you should not feel sharp "stabbing" pains. Stop exercising if you experience this excessive pain.

Consult your physician if pain persists.

- As with any form of exercise, you should perform a stretching routine before working out on your Vectra gym. This will help you develop a full range of motion, improve your joint flexibility, and eliminate the possibility of straining “cold” muscles.
- Be sure to breathe properly while you exercise. Your natural tendency is to hold your breath while lifting weights, which leads to a light-headed, dizzy sensation. Instead, exhale when lifting the weights and inhale when lowering the weights.
- Start your weight training with weights you can lift comfortably and increase the weight gradually. You’ll make quick progress without strain and soreness.
- Keep up the good work!

General Purpose Program

This next section presents a general purpose weight training program for your Vectra gym. This program is suitable for most people. If your fitness goal is overall conditioning, aerobic training, weight reduction/control, stress reduction, etc., this is the program for you.

This general purpose program features the use of relatively light weights and many repetitions. You exercise alternate muscle groups without taking rest periods between exercises. The On-Line® cable system lets you keep moving without pausing to adjust your machine, so you obtain the benefits of aerobic conditioning in addition to the benefits of weight training.

- Follow a “circuit” of exercises that alternates muscle groups, (i.e. chest press, leg extension, abdominal crunch, leg curl, etc.). Include a balance of upper body and lower body exercises. The poster included with your machine outlines a good starting program.
- Perform 10-15 repetitions of each exercise before moving to the next station on your circuit.
- Perform 2 or more complete circuits for your exercise session.
- Keep moving between stations to enhance the aerobic training effect and burn more calories.
- Follow your program at least every other day. If you exercise daily, take care to keep the weights light enough to avoid excessive muscle soreness.
- Select your starting weight at each station as follows. Begin with a weight that you can comfortably lift for 15 repetitions. Your muscles should feel tired but not painfully exhausted after 15 repetitions.
- After following your program for 1-2 weeks, begin increasing the weight gradually, one plate at a time. A good rule of thumb to follow is to go up a plate when you can perform 15 repetitions without feeling tired. Initially, it typically takes 2-3 weeks at a given weight to go up to the next level.

If you experience excessive muscle soreness, reduce the weight one plate and then continue exercising in sets of 10-15 repetitions.

Always increase weight gradually to avoid straining or pulling your muscles.

- Here is an example general purpose circuit you can use as a guide to develop your own exercise program.

1. Stretching/warm-up
2. Incline press
3. Leg extension
4. Abdominal crunch
5. Leg curl
6. Butterfly
7. Lat pulldown
8. Inner/outer thigh pull or squats

Specialty Program #1

This next section presents a specialty program for fitness enthusiasts who wish to maximize their muscle size and strength in a “body builder” type development program.

This development program should only be undertaken after 3-6 months of general fitness training. You should remember that professional athletes work all day, every day for years to reach their peak. You can achieve peak performance too, but work carefully and allow yourself plenty of time to reach your goals.

This specialty program emphasizes the use of relatively heavy weights and fewer repetitions. You perform 2 sets of repetitions at each station before moving to the next exercise, with a brief rest between sets. Vectra’s ball bearing pivots and all-steel construction allow you to lift heavy weights smoothly and confidently.

- Follow a “circuit” of exercises that concentrates on the muscle groups you want to develop, and includes exercises to maintain strength in your other muscle groups.
- Perform 2 sets of 5-8 repetitions of each exercise before moving to the next station. Rest for 1 minute between sets.
- Perform 1 complete circuit for your exercise session.
- Work out every other day. The rest day between exercise sessions prevents you from developing chronic muscle soreness.
- Select your starting weight at each station as follows. Begin with a weight that you can controllably lift for only 8 repetitions. Your muscles should feel quite tired after 8 repetitions.
- After following your program for 1-2 weeks, begin increasing the weight gradually, one plate at a time. A good rule of thumb to follow is to go up a plate when you can perform 8 repetitions without feeling tired. Initially, it should typically take 2-3 weeks at a given weight to go up to the next level.

If you experience excessive muscle soreness, reduce the number of repetitions to 5 and then continue exercising with the same weight.

Always increase the weight gradually to avoid straining or pulling your muscles.

Specialty Program #2

This next section presents a specialty program for sports enthusiasts who wish to optimize their performance in a specific sport.

Since overall fitness is essential to good performance in any sport, you should begin this program only after 3-6 months of general fitness training.

This program is based on the general purpose program described earlier, and incorporates some features of the muscle development program for concentrating on specific muscle groups.

The heavy weight/few repetitions principle is applied to the sports-specific muscle groups you want to develop. The light weight/many repetitions concept is applied to all other muscle groups to achieve all-around conditioning.

- Refer to your specialty dealer, sports coach, or weight training reference book for advice on specific exercises applicable to your sport.
- Incorporate these sports-specific exercises into a general-purpose program as described above. Use the heavy weight/5-8 repetitions concept described in the muscle development specialty program for these exercises.
- Enhance your total fitness profile by performing 3 general purpose circuits for each exercise session.

Routine Inspection and Maintenance

The Vectra On-Line® 1500 is designed to provide years of trouble-free service with minimal routine maintenance. You can be confident of continued top quality performance by carrying out the following periodic inspection.

PERFORM THE FOLLOWING CHECKS AT LEAST ONCE A MONTH.

1. Inspect cables and cable ends for visible wear, fraying or loose ends. Adjust cable system tension if necessary. **Replace any damaged or worn cables.**
2. Inspect frame and pulley bolts for tightness. Tighten if necessary.*
3. Inspect accessory items (lat bar, curl bar, abdominal strap, ankle strap, etc.) for damaged mounting eyes, broken stitches, etc. Replace any damaged items.
4. Inspect weight selector pin for proper fit in selector shaft. Replace improperly functioning pin with Vectra replacement pin only.
5. Inspect handlebar adjustment lever for proper engagement. Replace improperly functioning parts only with VECTRA replacement parts.
6. Inspect handlebar mounting screws for tightness. Tighten if necessary.*
7. Inspect incline bench mounting bolts. The seat brace to seat back mounting bolts should be snug but not clamped tight. Tighten mounting bolts if necessary.*
8. Inspect leg developer mounting screws for tightness. Tighten if necessary.*
9. Inspect leg/ab seat pivot mounting bolt for tightness. Tighten if necessary.*
10. Inspect leg developer and butterfly quick connect cable mounting screws. Tighten screws if necessary.
11. Inspect press arm mounting screws for tightness. Tighten if necessary.*
12. Inspect all foam hand grips. Replace any damaged, worn, or loose hand grips.
13. Inspect weight plates for cracks, damaged bushings, etc. Replace if necessary.
14. Vectra's stainless steel guide rods DO NOT REQUIRE LUBRICATION or anti-rust treatment. Simply keep them free of grit, sticky or gummy sprays, etc.
15. Clean upholstery with mild soap and water as desired.
16. If unit is in a humid area, such as near a pool, hot tub or sauna, or in certain climates, use of an auto wax should delay rusting.

* If any bolts seem to loosen periodically, use loctite 242 for a long-term cure.

VECTRA

ON-LINE® 1500

CABLE DIAGRAM

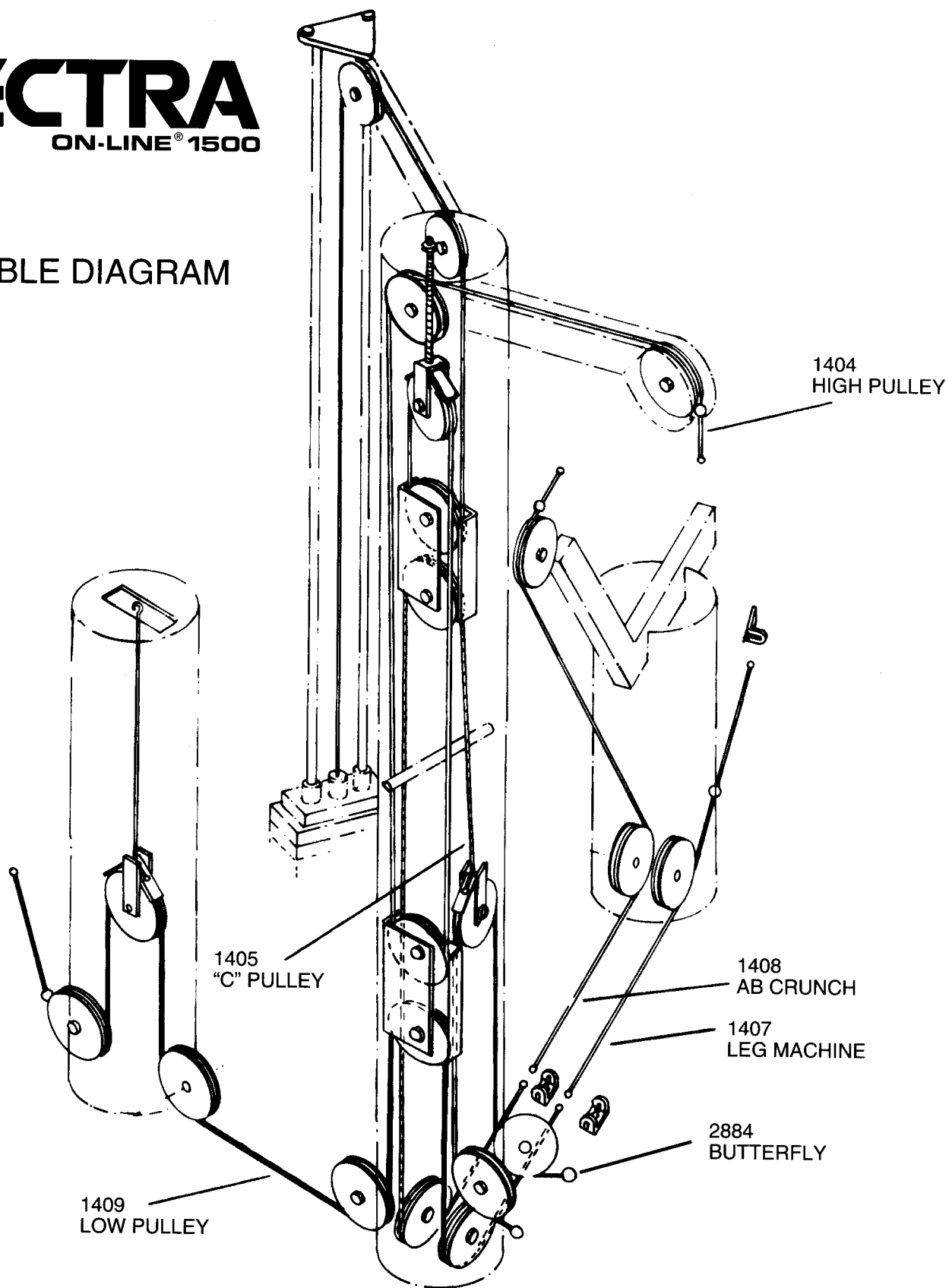

Vectra 1500 Limited Warranty

Vectra Fitness, Inc. warrants, to the original owner only, this Vectra On-Line 1500 to be free from defects in materials and workmanship for component specific periods as outlined below. Purchaser must retain bill of sale to establish warranty rights. This warranty is valid only if machine is purchased from a Vectra authorized dealer. Defective parts will be repaired or replaced at Vectra's option, when returned to Vectra Fitness, Inc. prepaid with prior authorization. No allowances for labor will be made.

Warranty Period: (All periods are from date of purchase by original consumer)

Home Use:

Structural Frame	10 years	Cables	1 year
Weight Stack	5 years	Bearings	1 year
Pulleys	5 years	Upholstery	1 year
Guide Rods	5 years	Other parts not listed	1 year

Home use is defined as use in a family's home by the members of that family.

Commercial/Institutional use:

This warranty is void if this machine is used in any type of commercial or institutional setting.

Conditions and Exceptions: Failures due to normal wear, damage, misuse, abuse, neglect, alteration, improper assembly, repairs other than by an authorized Vectra Service Center, or lack of maintenance are not covered. Use of a weight stack that is heavier than the heaviest stack that Vectra Fitness sells for use on the machine voids this warranty. This warranty does not cover damages sustained during shipment. Title passes to buyer upon delivery to carrier. If product is damaged in transit, file claim with carrier.

Repairs to the Structural Frame and Weight Stack will be made only if such repairs are necessary to make the machine functional as designed. Repairs for other reasons will not be made. Cosmetics are not covered by this warranty. This is a powder coated steel product, and as such rust-resistant in most settings Any rusting and/or corrosion is completely outside the scope of this warranty. Owners who live in humid climates or intend to install this machine in a humid area such as outside, near a pool, hot tub, or sauna should apply an automotive wax to delay rusting. The corrosive effects of sweat, cleaners, body lotions, sunlight, etc. are also the responsibility of the owner.

It is our policy to replace components rather than entire machines or assemblies. It is also our policy to repair rather than replace frame components. Such repairs of structural parts will be made using appropriate technology and may be visible. Repaired items will be repainted as needed, but the new paint may not match the old.

Replacement and Repair Expenses: Vectra Fitness will provide only replacement parts or repair to parts under this warranty, and will pay for standard ground shipping of such parts to the consumer. The owner of the machine is responsible for all other costs. Such costs may include, but are not limited to: labor charges for service, removal, repair, and re-installation of the Vectra product or any component part; shipping, delivery, handling, and administrative charges for returning parts to Vectra; all necessary or incidental costs related to installation of the replacement part.

Claim Procedure: Please contact the Vectra authorized dealer from whom you purchased your machine should warranty service be required. Items returned to Vectra without prior factory authorization or freight collect will not be accepted. Vectra assigned RMA number MUST be prominently shown on OUTSIDE of carton. Copies of original bill of sale MUST accompany any merchandise returned for warranty service. Also each returned item must be accompanied by the following information: RMA number assigned by Vectra, product serial number, description of problem experienced, and instructions for return of repaired/replaced part. Parts should be shipped to Vectra Fitness in their original carton or equivalent packaging. Vectra Fitness will not be responsible for any loss or damage incurred in shipping.

No other express warranty has been made or will be made on behalf of Vectra Fitness with respect to any Vectra product or the operation, repair or replacement of any Vectra product. Vectra Fitness shall not be responsible for injury, loss of use of the Vectra product, inconvenience, loss or damage to personal property, whether direct or indirect, and incidental or consequential damages. This warranty is LIMITED STRICTLY to the terms stated herein and no other express warranties or remedies shall be binding on us. THIS WARRANTY AND ALL WARRANTIES WHICH MAY BE IMPLIED UNDER STATE LAW, INCLUDING, BUT NOT LIMITED TO, WARRANTIES OF MERCHANTABILITY AND WARRANTIES OF FITNESS FOR ANY PARTICULAR PURPOSE, EXPIRE WITH THE TRANSFER OF OWNERSHIP FROM THE ORIGINAL OWNER. ANY IMPLIED WARRANTY OF MERCHANTABILITY OR FITNESS FOR ANY PARTICULAR PURPOSE SHALL BE LIMITED TO ONE YEAR FROM DATE OF PURCHASE. REPAIR OF THE PRODUCT AS PROVIDED UNDER THIS WARRANTY IS THE EXCLUSIVE REMEDY OF THE CONSUMER. IN NO EVENT SHALL WE BE LIABLE FOR INCIDENTAL OR CONSEQUENTIAL DAMAGES, FOR BREACH OF THIS WARRANTY, OR ANY OTHER WARRANTY EXPRESS OR IMPLIED. Some states do not allow limitations on how long an implied warranty lasts, or do not allow the exclusion of incidental or consequential damages, so the above limitations or exclusions may not apply to you.

Consumers Rights: This Limited Warranty gives you specific legal rights, and you may also have other rights which vary from state to state.

Vectra Fitness, Inc.
15135 N.E. 90th Street
Redmond, WA 98052, U.S.A.

Protected by one or more of the following Patent Numbers: RE34,572; 4,900,018; 4,986,538; 5,336,148; 5,378,216; 5,395,295; 5,462,510; D320,246; D320,247; D320,248; D329,563; CN1,309,738; CN2,023,972.

Other U.S. and foreign patents pending.

PN 15490, Rev.- 3/96